

FT101TMIP69KCAPHBOB

v1: GL: 3030516990 | EU: 4010078986

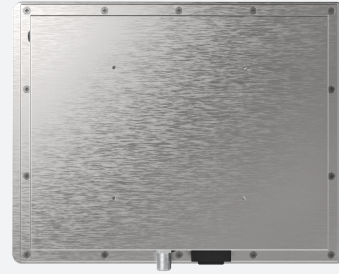
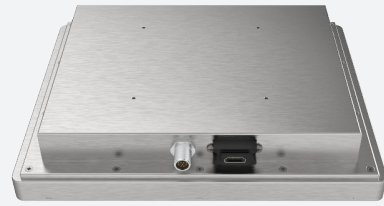

Pictures show sample configurations, real product may vary.

DISPLAY

Display Size [inch]	10.1
Aspect Ratio	16 : 10
Resolution	1280 × 800
Active Area [mm]	216.96 × 135.60
Brightness [cd/m²]	1000+
Contrast Ratio	1000 : 1
LED life time [h]	100,000
Viewing Angle [°]	170 / 170
Display Interface	LVDS

TOUCH PANEL

Touch Type	Projected Capacitive 10-point Multi-touch
Printing Type	Ceramic
Glass Thickness [mm]	2.0
Cover Glass Surface Treatment	AG (chemical etching)
IK Protection	IK08
Printing Color	RAL9004 (Black)
Strengthening	Thermally Strengthened
Touch Controller	EXC81W60
Touch Interface	USB
Touch Resolution RX	39
Touch Resolution TX	24
Optical Bonding	Clear Bond®

PC/MONITOR SYSTEM

Monitor Controller	Realtek® RTD2556T
Monitor Firmware	Standard
Loudspeaker	2× 2W
IP69K 9-36V M12 connector (12 pin)	1
IP69K HDMI connector	1
Ambient Light Sensor	1

Adjustable Features

Brightness, Contrast, Screen Setting, Color Temp, Color Effect, Language, Reset, Auto Adjust (see instruction manual for full details)

ENVIRONMENTAL CONDITIONS

Operation Temperature	-10°C to 60°C
Storage Temperature	-20°C to 70°C
Humidity Range	10% to 90%

CERTIFICATIONS

CE Certificate	Yes
FCC Certificate	Yes

M12 CONNECTOR PIN DEFINITION

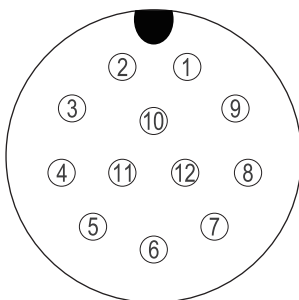

1	VCC (power)
2	VCC (power)
3	GND
4	GND
5	RX (serial)
6	TX (serial)
7	GND
8	Vbus (touch)
9	D- (touch)
10	D+ (touch)
11	GND
12	NC

CHASSIS

Case Design	SS-IP69K
IP Protection	Full IP69K
Case Color	Silver
Case Finish	Brushed
Case Material	Stainless Steel
Case size L × W × H [mm]	272.8 × 214.4 × 51.2
Mounting	VESA 100 × 100

IP69K CONNECTORS

Above connectors have IP69K connector seals / locks.

ACCESSORIES

Power Adapter with IP69K cable	No, optional
HDMI Touch Cable	No, optional
Short Instruction manual	Yes

POWER

Power Indicator	Green LED
Working Power	9-36V
Power Consumption	15W
Stand-By Consumption	<1W

INTENDED USE/APPLICATION

The device is to be used as (touchscreen) display for outdoor or indoor use as control panel, digital signage, way-finding, POS and similar applications.

The device has a wide temperature range and is suitable for outdoor use, even in environments with direct sunlight (1090 W/m² Sunlight radiation), or frequent rain showers. This IP69K version is also capable to withstand high-pressure and high-temperature water jets without any issues.

WEIGHT & PACKAGING

Net Weight	~3.10 kg est.
Gross Weight	~4.20 kg est. (incl. Cartonage)
Packaging Material	100% recyclable cardboard and polyethylene (PE)
Packaging Size L x W x H [mm]	433.0 x 290.0 x 80.0

DIMENSIONS

10.1" IP69K CAPACITIVE TOUCH MONITOR

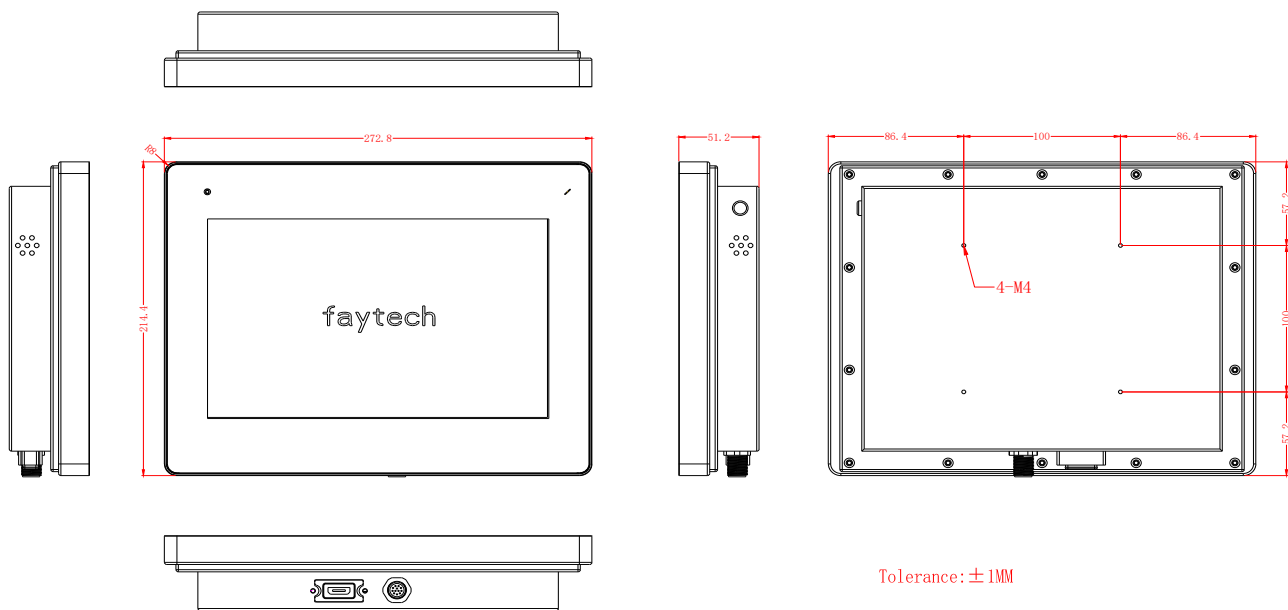

UPDATE NOTES:

Version:	Changes:
v1	First version

